

CORNER SINGLE AUGER 1051

SPECIFICATIONS

Model	1051	
Undercarriage	Tracks	Flotation Tires
Specifications		
Heaped capacity*	1050 bu.	1050 bu.
Unload speed - maximum**	475 bu/min	475 bu/min
Total weight - empty	24,420 lbs.	15,100 lbs.
Hitch weight - empty	2,500 lbs.	2,500 lbs.
Hitch weight - loaded	5,000 lbs.	5,000 lbs.
Width - grain tank	12'-4"	12'-4"
Length - grain tank	19'-4"	19'-4"
Height - short side	11'-9"	11'-9"
Height - high side	12'-9"	12'-9"
Length - overall	30'-7"	30'-7"
PSI capacity***	11 psi	23 psi/ 29 psi diamond float
Tractor Requirements (minimum)		
Tractor horsepower	250 hp	
Tractor hydraulics	3 SCVs; 2,320 system psi	
Features and options		
Vertical auger	STD with 20" diameter flighting with a 21" diameter tube	
Gearbox	STD with 90 degree, 3.5" - 4" pitch cut gears, 2:1 ratio	
PTO	STD with 1-3/4" diameter, 20 spline, 1000 rpm PTO	
Tracks	36" x 100" contact area	---
Diamond tread tires	---	OPT; 900/60 R32
Lug tread tires	---	OPT; VF 1050/50 R32
5-point scale package	OPT	OPT
Scale-Tec Point® scale indicator	OPT	OPT
GT400 scale display	OPT	OPT
Remote scale readout	OPT	OPT
Roll tarp - manual	OPT	OPT
Safety chains	STD	STD
Adjustable spout	STD	STD

*Cart capacity and hitch weight are based on #2 corn at 15% moisture (56lb test weight). Cart capacity and hitch weight may vary based on crop type, grade, moisture and other environmental factors.

**Approximate with 15% moisture corn. Bushels/minute will vary with moisture content of grain and/or PTO rpm.

***Comparative PSI @ 3" soil penetration depth using 56 lb. test weight grain at 15% moisture at posted capacities.

Tracks

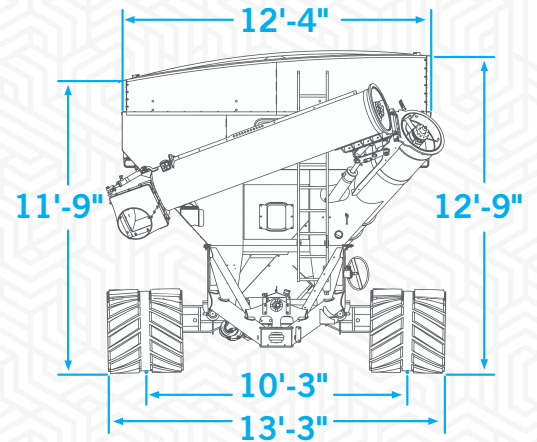

Flotation Tires

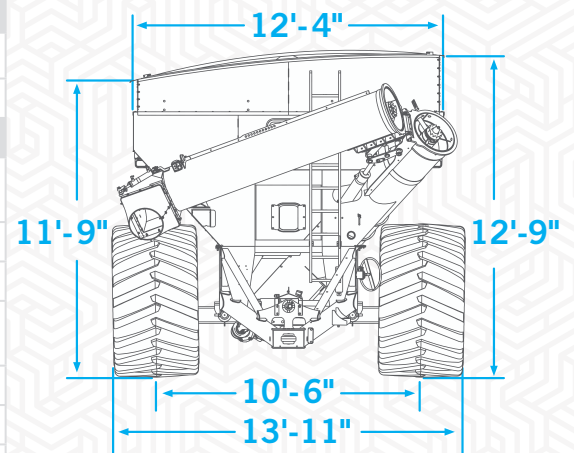

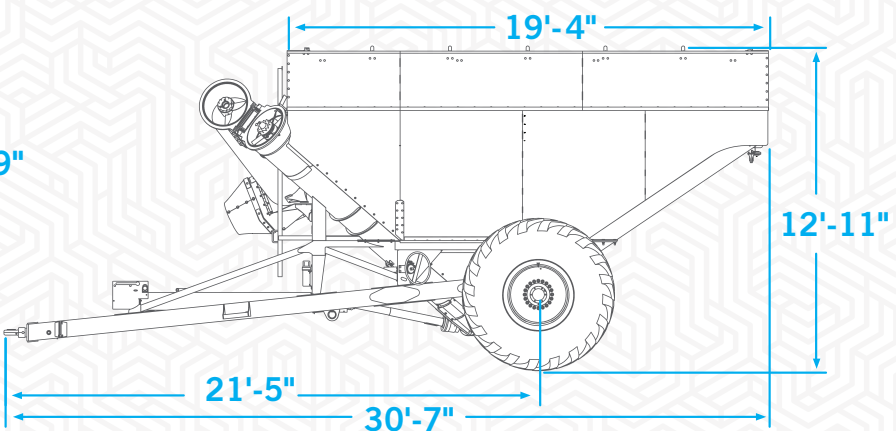
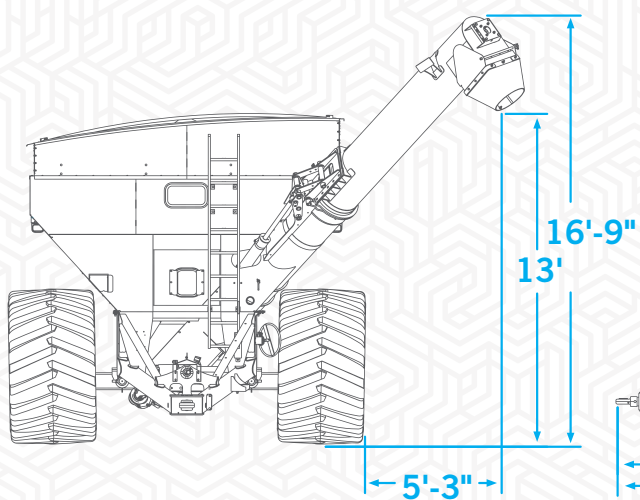
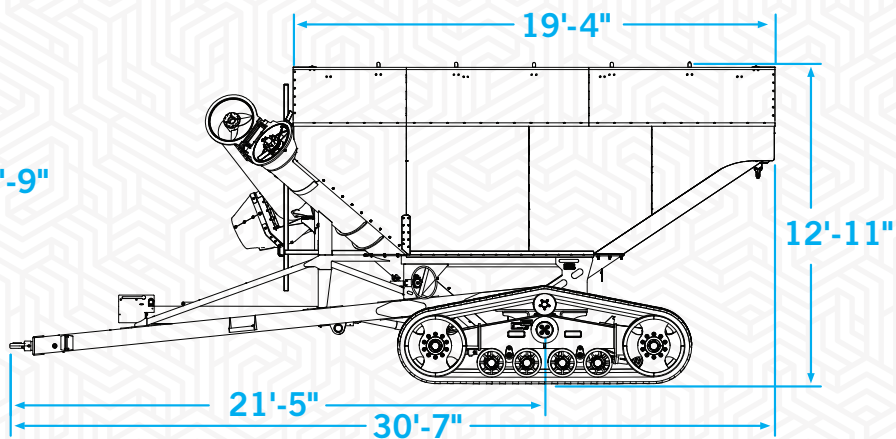
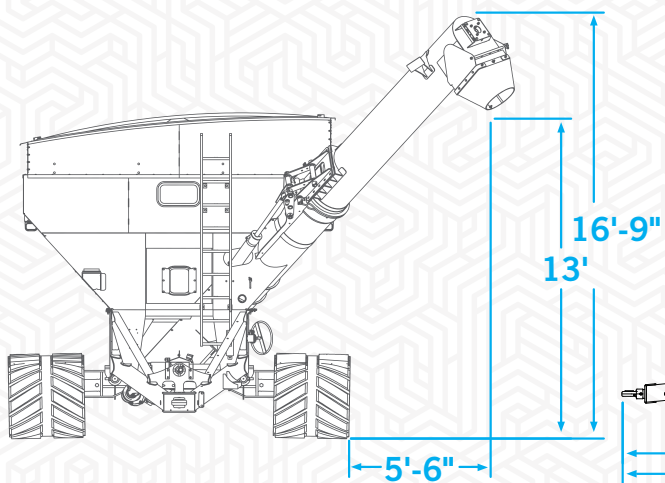



KINZE®

Kinze Manufacturing, Inc. • I-80 at Exit 216
Williamsburg, Iowa 52361-0806 USA • visit kinze.com

© 2025 by Kinze Manufacturing, Inc. Kinze®, the Kinze® logo, are trademarks owned by Kinze Manufacturing, Inc. Kinze Manufacturing, Inc. reserves the right to make changes in engineering, design and specifications, or add improvements at any time without notice or obligation.



SCAN ME

Visit Kinze.com for the most current product information.

Authorized Dealer: