

# DUAL AUGER 1121

## SPECIFICATIONS

Model	1121		
Undercarriage	Tracks	Flotation Tires	Row Crop Tires
Specifications			
Heaped capacity*	1125 bu.	1100 bu.	1100 bu.
Unload speed - maximum**	550 bu/min	550 bu/min	550 bu/min
Total weight - empty	28,040 lbs.	20,880 lbs.	21,440 lbs.
Hitch weight - empty		3,820 lbs.	3,820 lbs.
Hitch weight - loaded	6,260 lbs.	6,260 lbs.	6,260 lbs.
Width - overall	12'-0"	12'-1"	12'-0"
Length - overall	30'-10"	30'-10"	30'-10"
Height - short side	10'-11"	11'-0"	11'-0"
Height - high side	12'-0"	12'-1"	12'-1"
PSI capacity***	12 psi	23 psi	25 psi
Tractor Requirements (minimum)			
Tractor horsepower	250 hp	250 hp	250 hp
Tractor hydraulics	3 SCVs; 2,320 system psi		
Features and options			
Vertical auger	STD with 20" diameter flighting with a 22" diameter tube		
Horizontal auger	STD with 20" diameter flighting with a 22" diameter tube		
Gearbox	STD with 90 degree, 3.5" - 4" pitch cut gears, 2:1 ratio		
Drive belts	STD with two 4-band, multi-strand V-belts		
Drive sheaves	STD with 8-groove 7-1/2" diameter drive and 15" diameter driven sheaves		
PTO	STD with 1-3/4" diameter, 20 spline, 1000 rpm PTO		
Tracks	36" x 100" contact area	---	---
Flotation tires	---	OPT; 1250/45R32	---
Row crop tires	---	---	OPT; 480/80 R42
3-point scale package	STD	STD	STD
Scale-Tec Point® scale indicator	OPT	OPT	OPT
GT400 scale display	OPT	OPT	OPT
Remote scale readout	OPT	OPT	OPT
Roll tarp - manual	STD	STD	STD
Safety chains	STD	STD	STD
Adjustable spout	STD	STD	STD

\*Cart capacity and hitch weight are based on #2 corn at 15% moisture (56lb test weight). Cart capacity and hitch weight may vary based on crop type, grade, moisture and other environmental factors.

\*\*Approximate with 15% moisture corn. Bushels/minute will vary with moisture content of grain and/or PTO rpm.

\*\*\*Comparative PSI @ 3" soil penetration depth using 56 lb. test weight grain at 15% moisture at posted capacities.

### Tracks

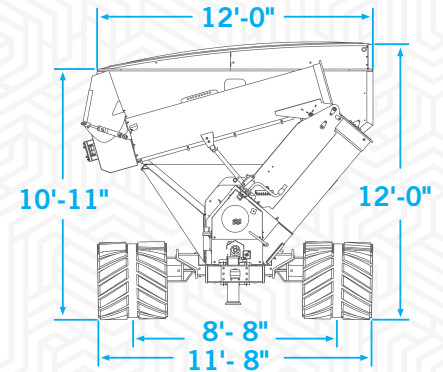

### Flotation Tires

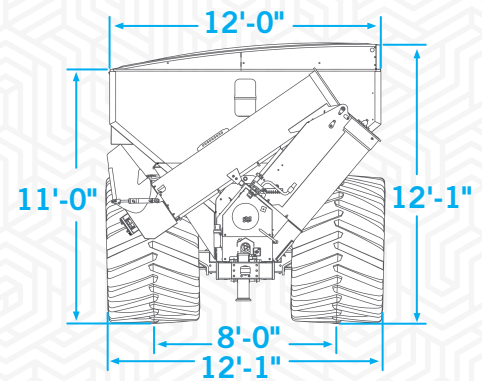

### Row Crop Tires

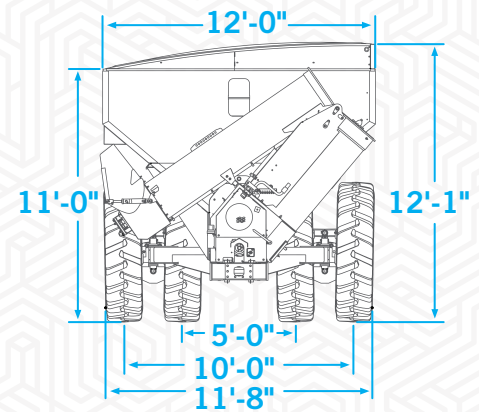



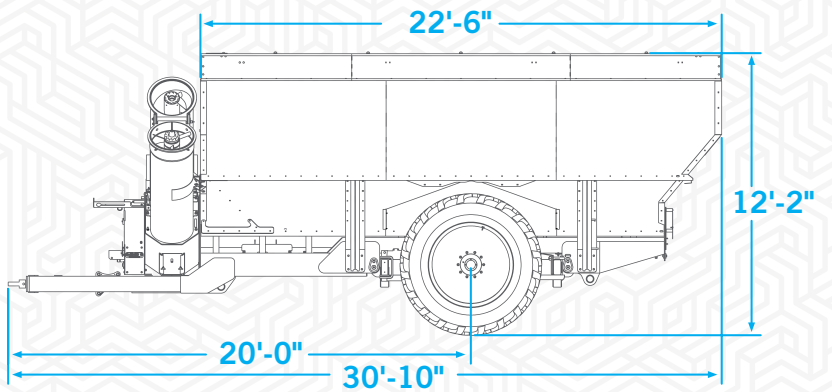
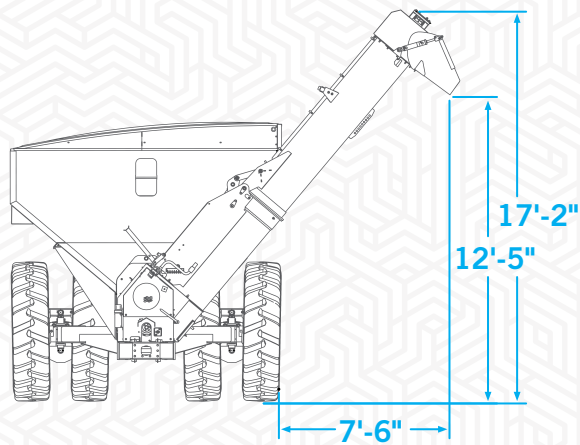
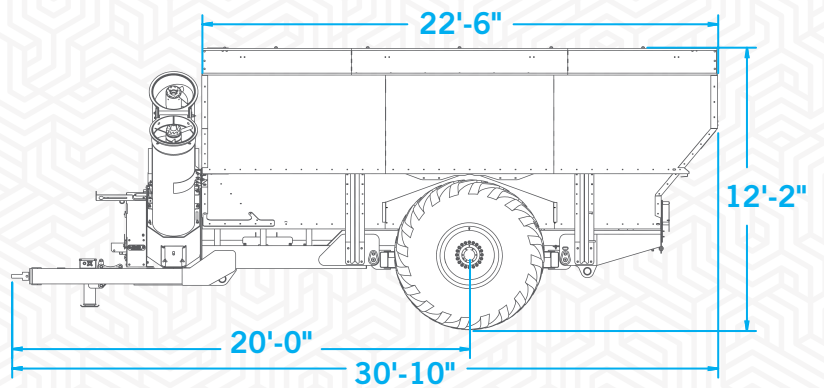
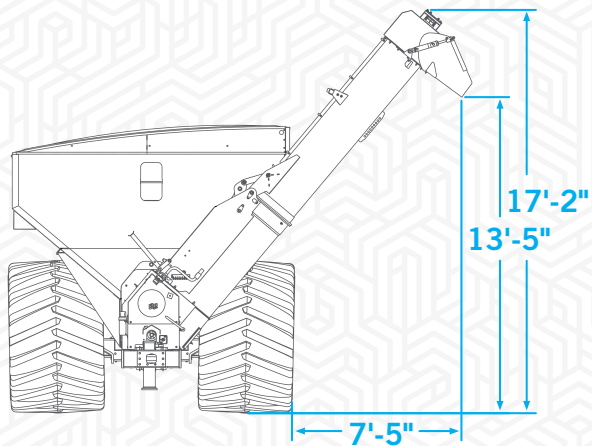
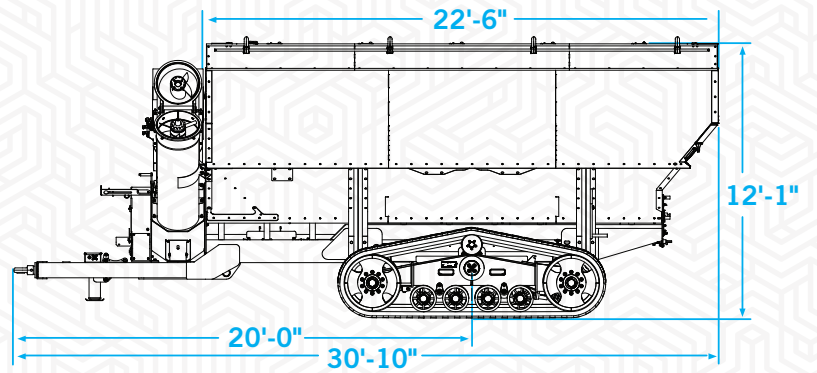
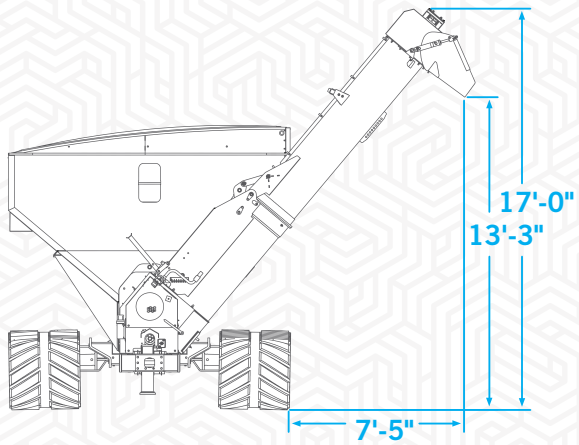





# KINZE®

Kinze Manufacturing, Inc. • I-80 at Exit 216  
Williamsburg, Iowa 52361-0806 USA • visit [kinze.com](http://kinze.com)

© 2025 by Kinze Manufacturing, Inc. Kinze®, the Kinze® logo, are trademarks owned by Kinze Manufacturing, Inc. Kinze Manufacturing, Inc. reserves the right to make changes in engineering, design and specifications, or add improvements at any time without notice or obligation.



SCAN ME

Visit [Kinze.com](http://Kinze.com) for the most current product information.

Authorized Dealer: